

SA01LPBT

SpaceArm Laptop Platform Bolt Through Mount

Required Tools:

17 mm socket and extension
5mm Allen wrench

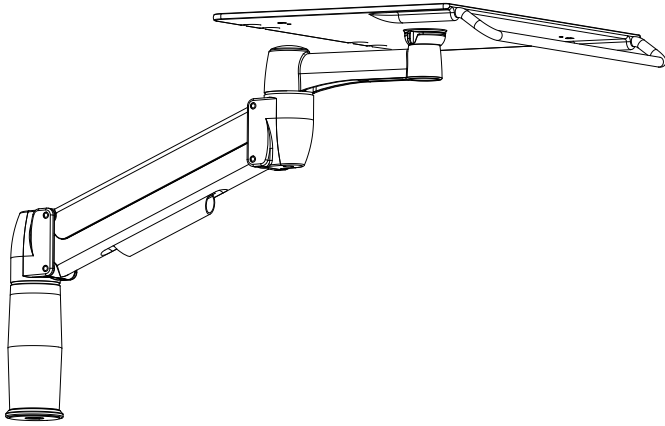

US Patent: 6,695,270 B1 6,758,454 B2 7,316,377 B2



Adjusting Counter Balance

* Required Tool: 5mm Allen Wrench

Position Arm
so it is parallel
to desk surface.

Turn bolt
clock wise
for Lighter monitors.
Turn bolt
counter clockwise
heavier monitors.

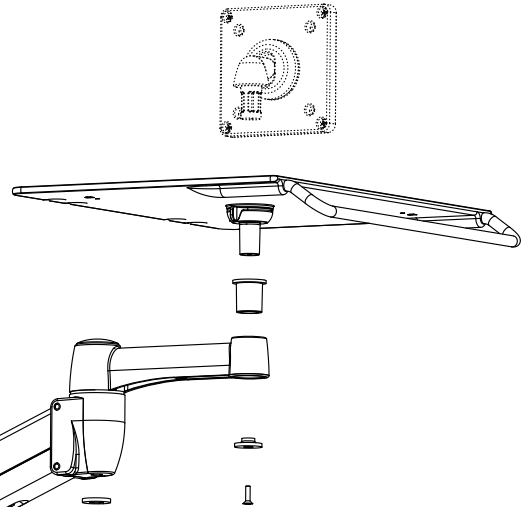
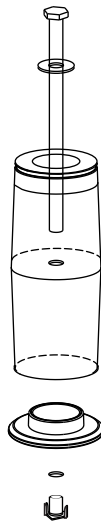
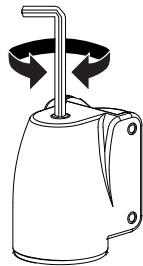

DISCLAIMER OF DAMAGES FOR IMPROPER USE. SpaceCo shall not be responsible for damage to its products, or injuries or damages caused by its products, resulting from improper installation, maintenance, unintended use or attempts to operate such products beyond their mechanical capacity, intentionally or otherwise, or by reason of unauthorized repair.

SpaceCo Business Solutions, Inc.
800.840.8499
www.spaceco.com